

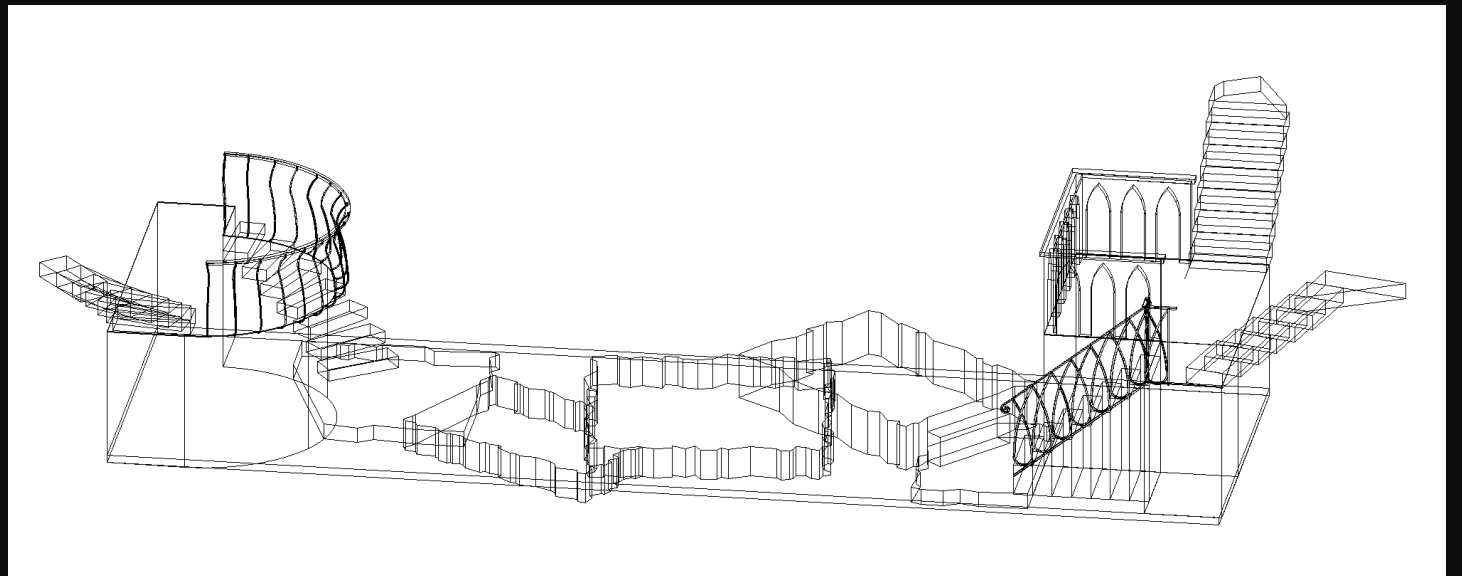

Evelyn Hassett

Production Design Portfolio

Theatre

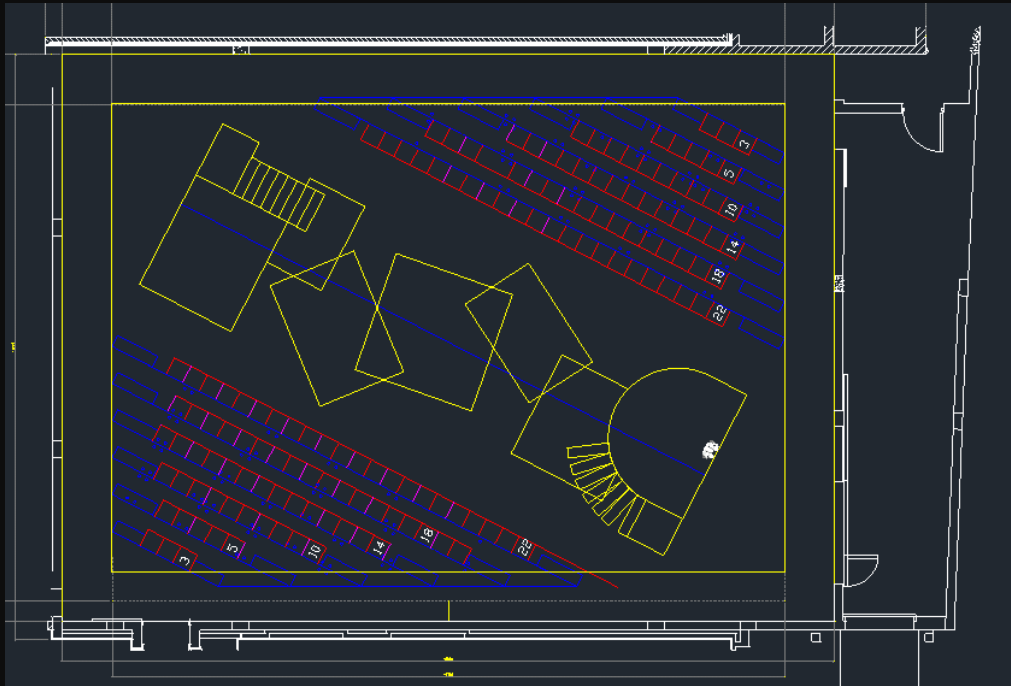
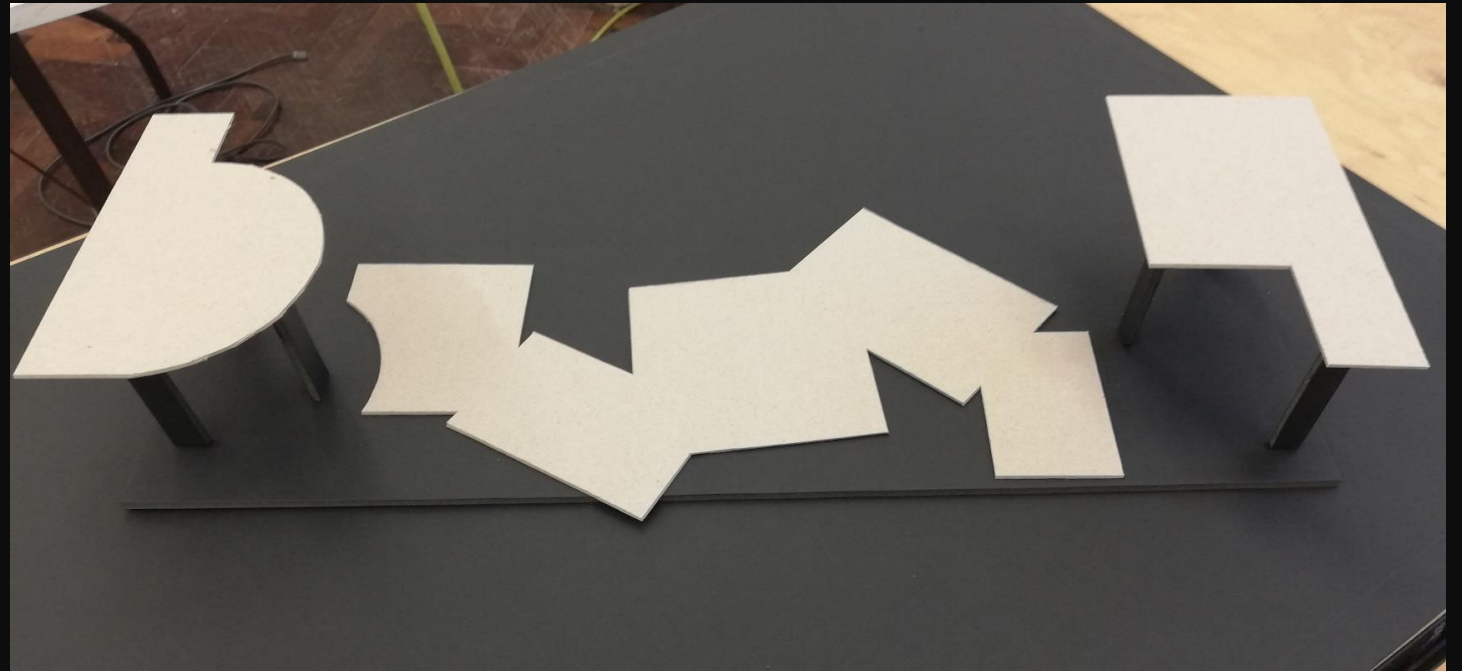

Merchant of Venice – Willian Shakespeare – Project Theatre - Set Design Process (2021)

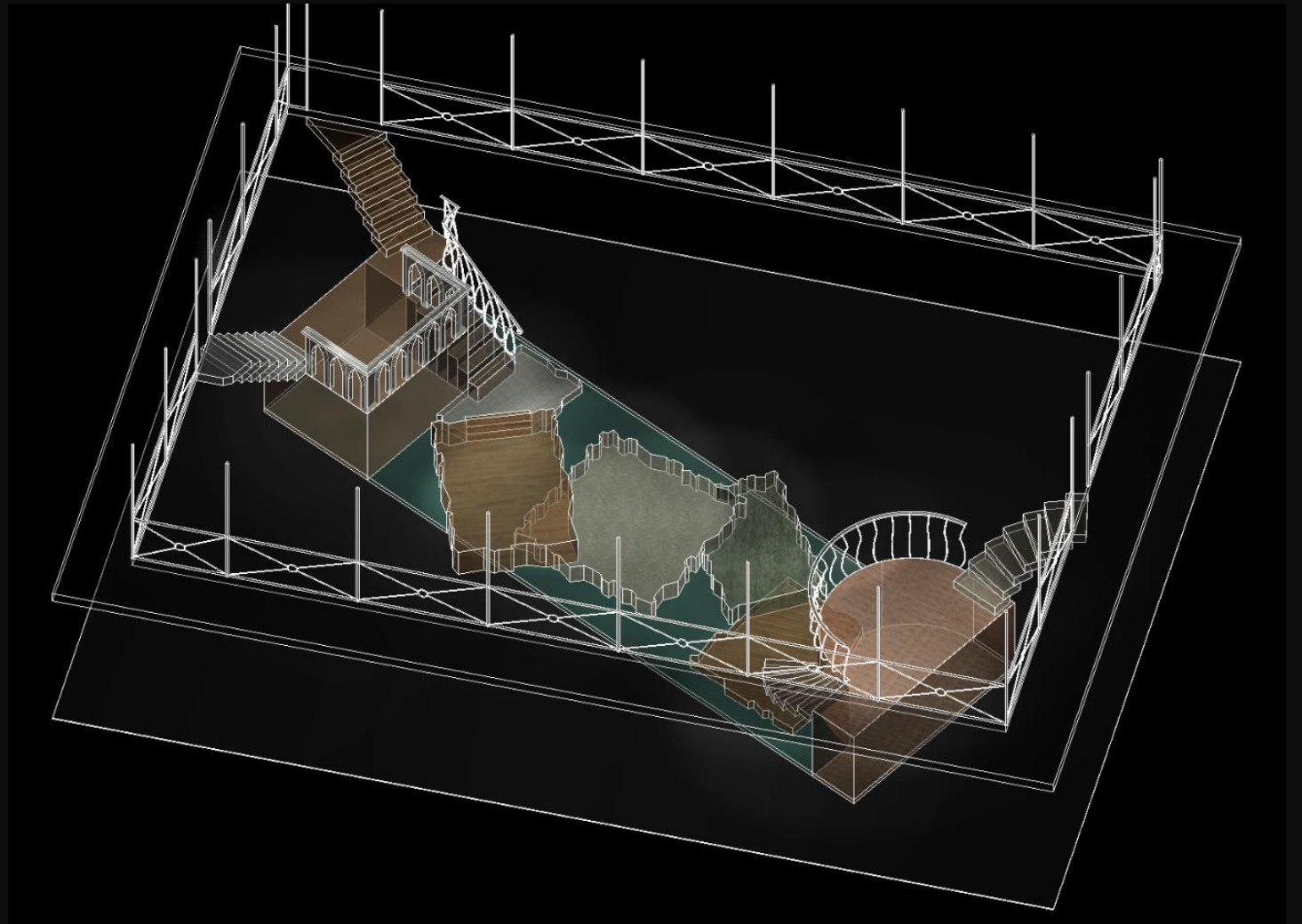
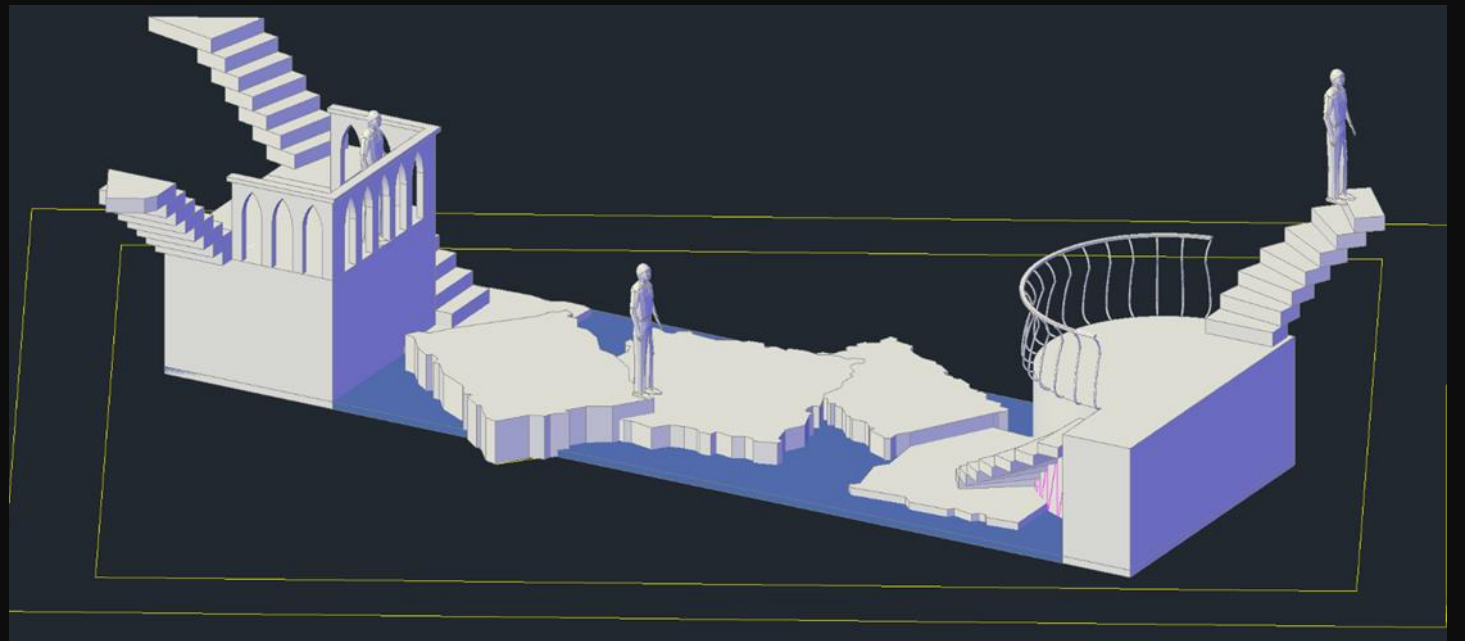
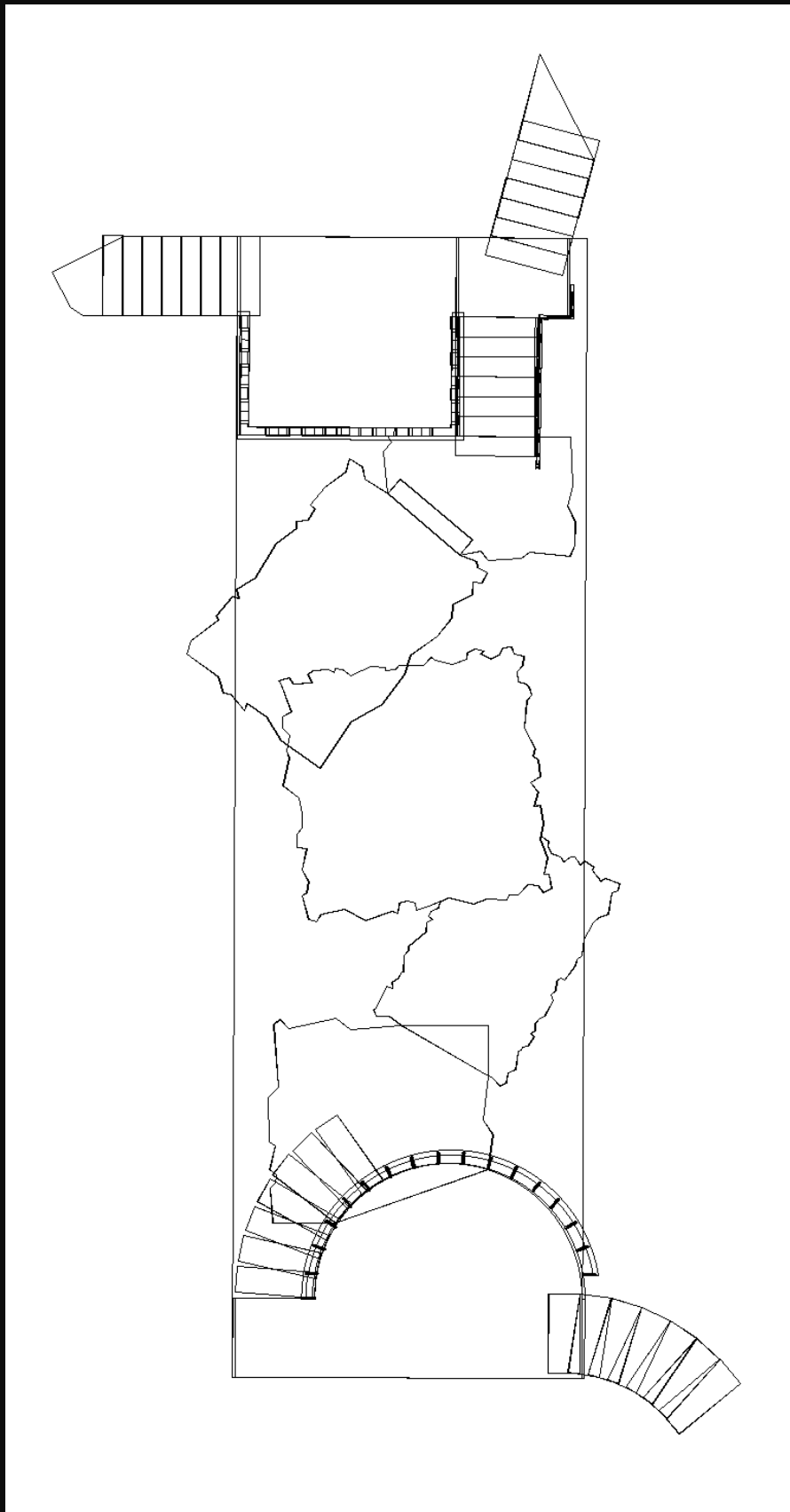

Merchant of Venice – Willian Shakespeare – Project Theatre - Set Design (2021)

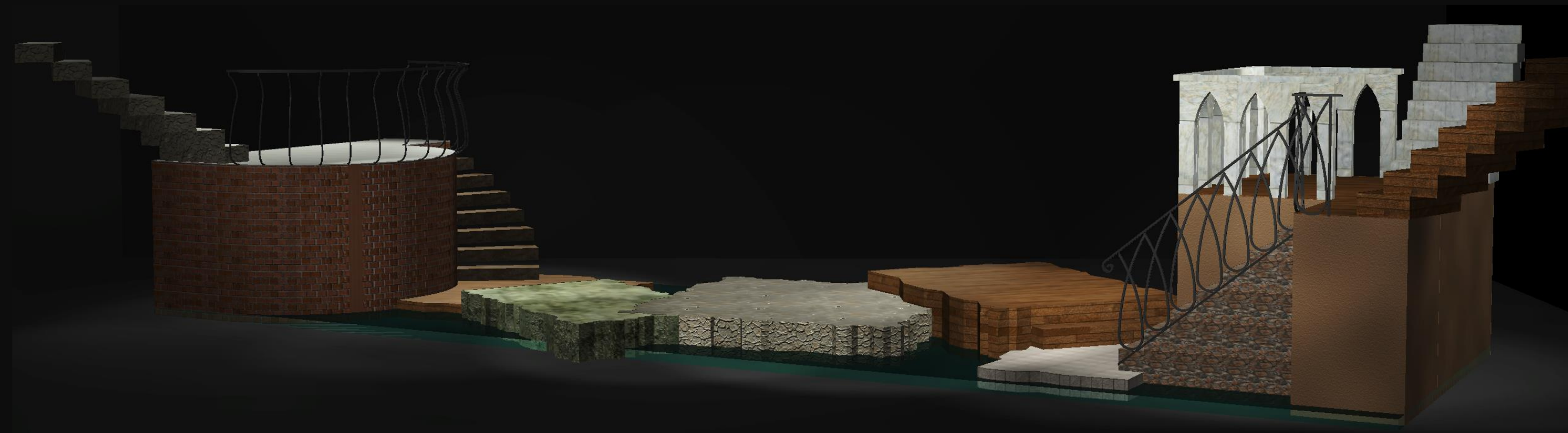

Merchant of Venice – Willian Shakespeare – Project Theatre - Set Design (2021)

Street, Venice: Act 1, Scene 3 – Antonio asks Shylock for a loan on Bassanio's behalf

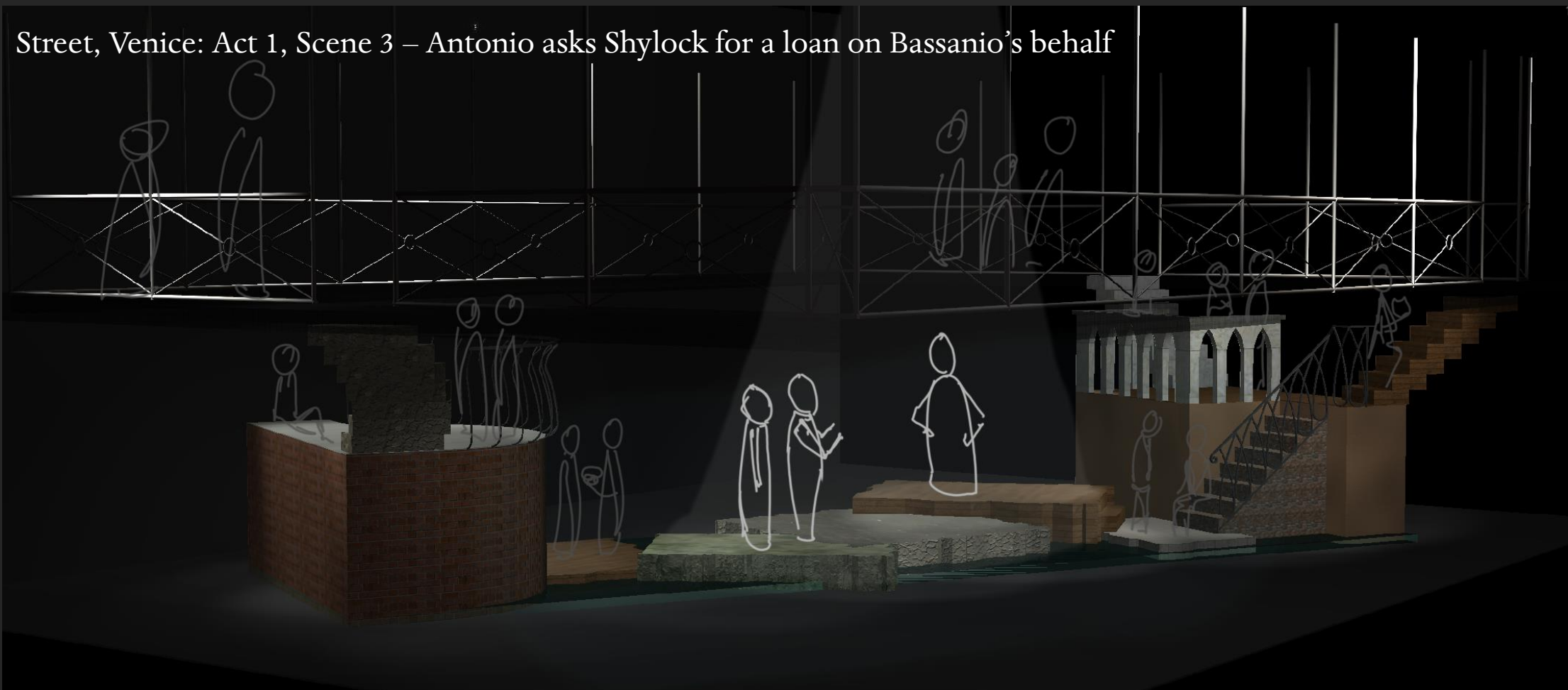

Portia's House, Belmont: Act 3, Scene 2 – Bassanio debates which casket to pick to win Portia



Courtroom: Act 4, Scene 1 – Shylock loses the court case against Antonio

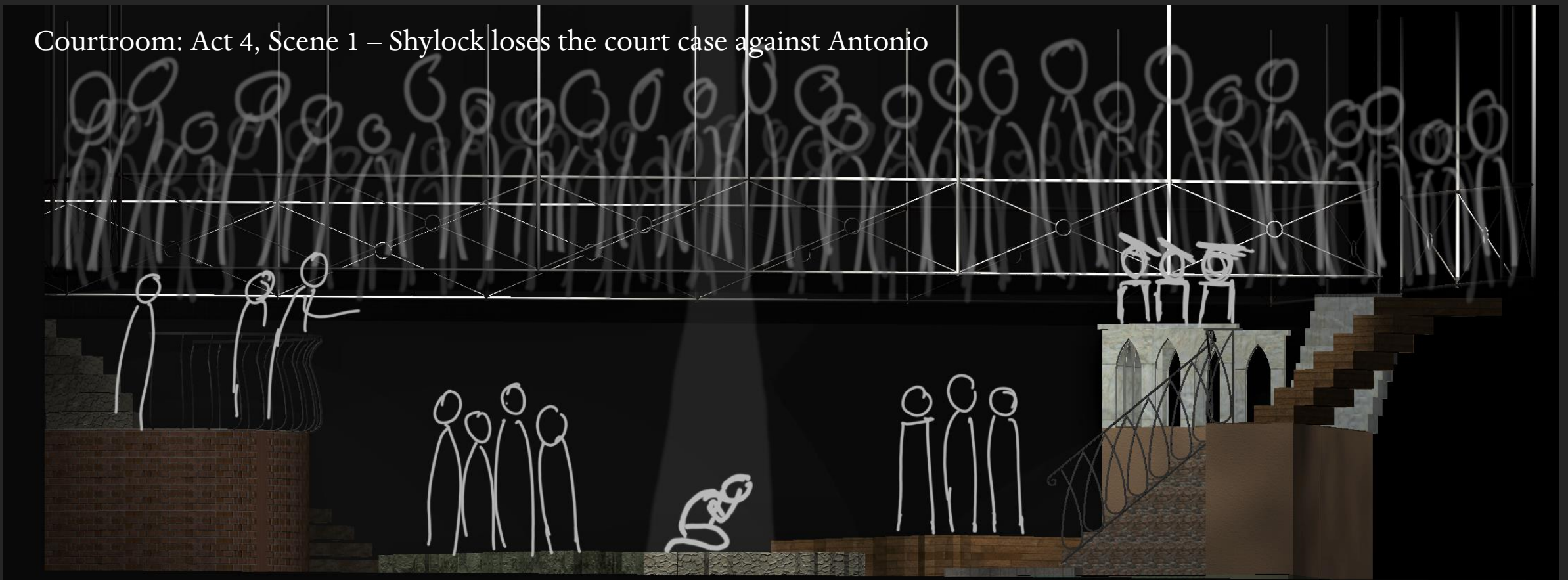

Portia's Garden, Belmont: Act 5, Scene 1 – Lorenzo & Jessica's Walk





Merchant of Venice – Willian Shakespeare – Project Theatre - Set Design (2021)



Four Plays for Dancers – W.B. Yeats

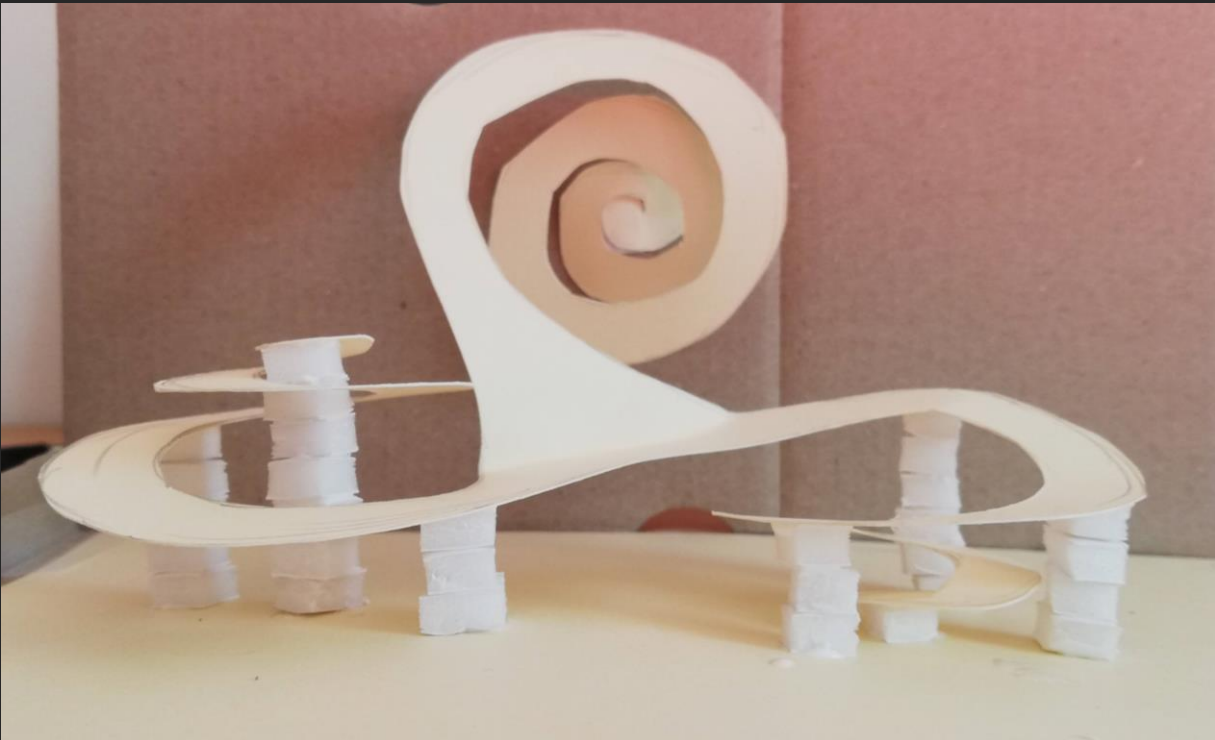
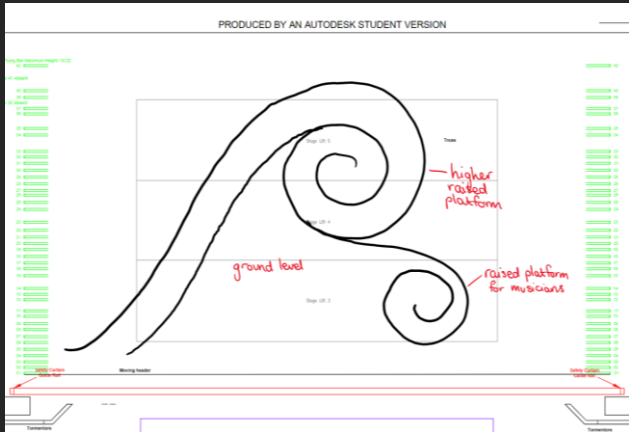

Four Plays for Dancers – W.B. Yeats – Abbey Theatre - Production Design (2021)

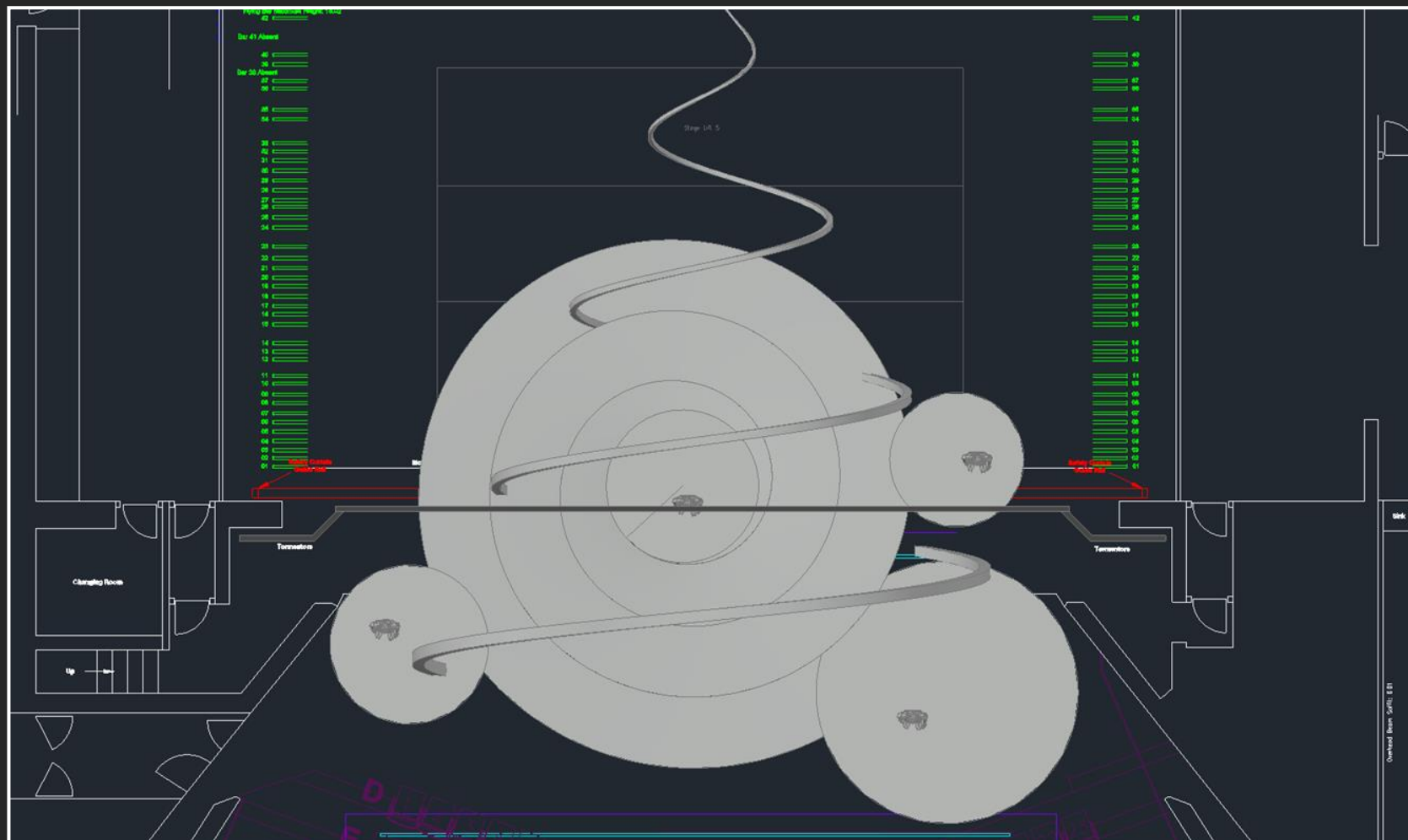
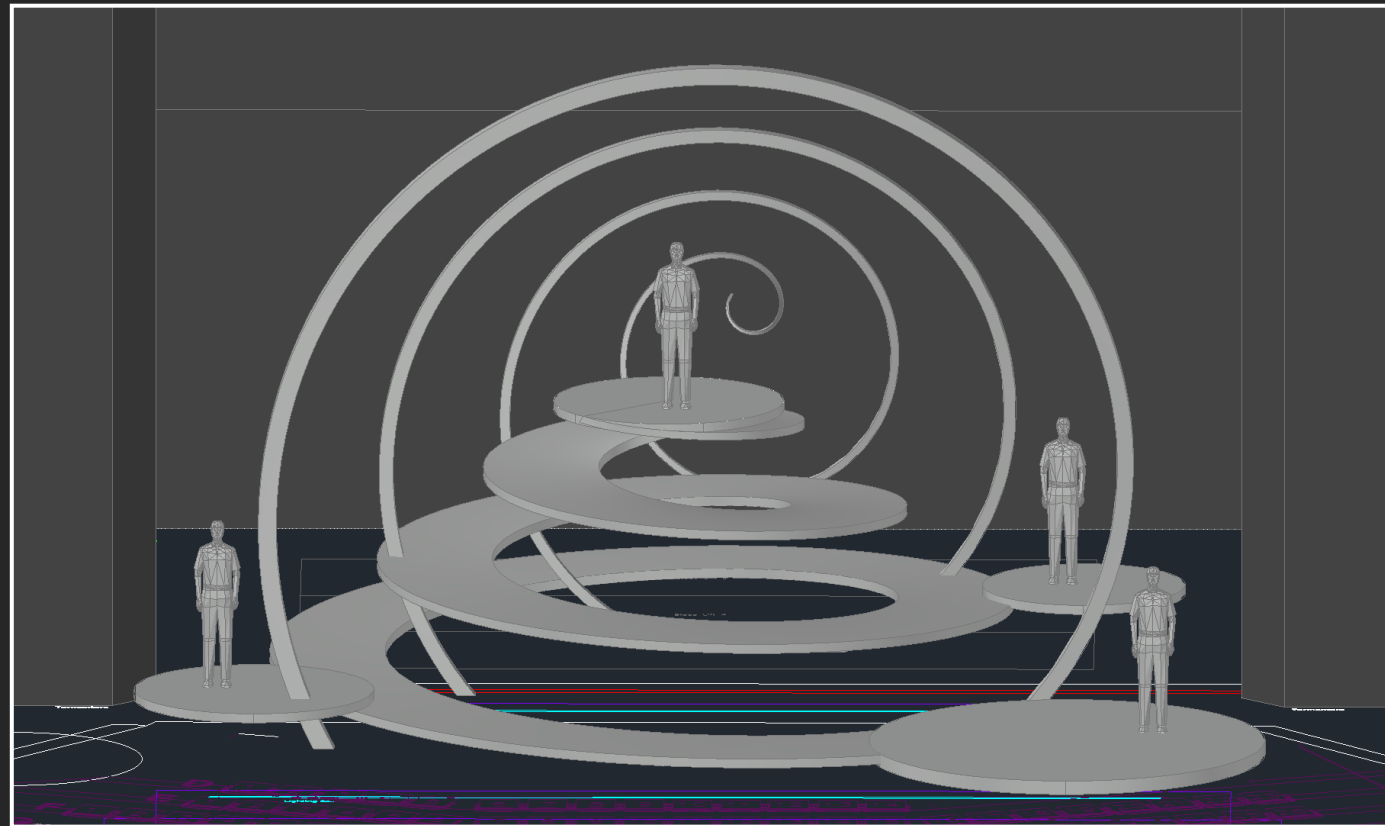

Four Plays for Dancers - AutoCAD Drawings – Abbey Theatre - Front View and Floorplan (2021)



Four Plays for Dancers
Irish Bronze-Age Jewellery

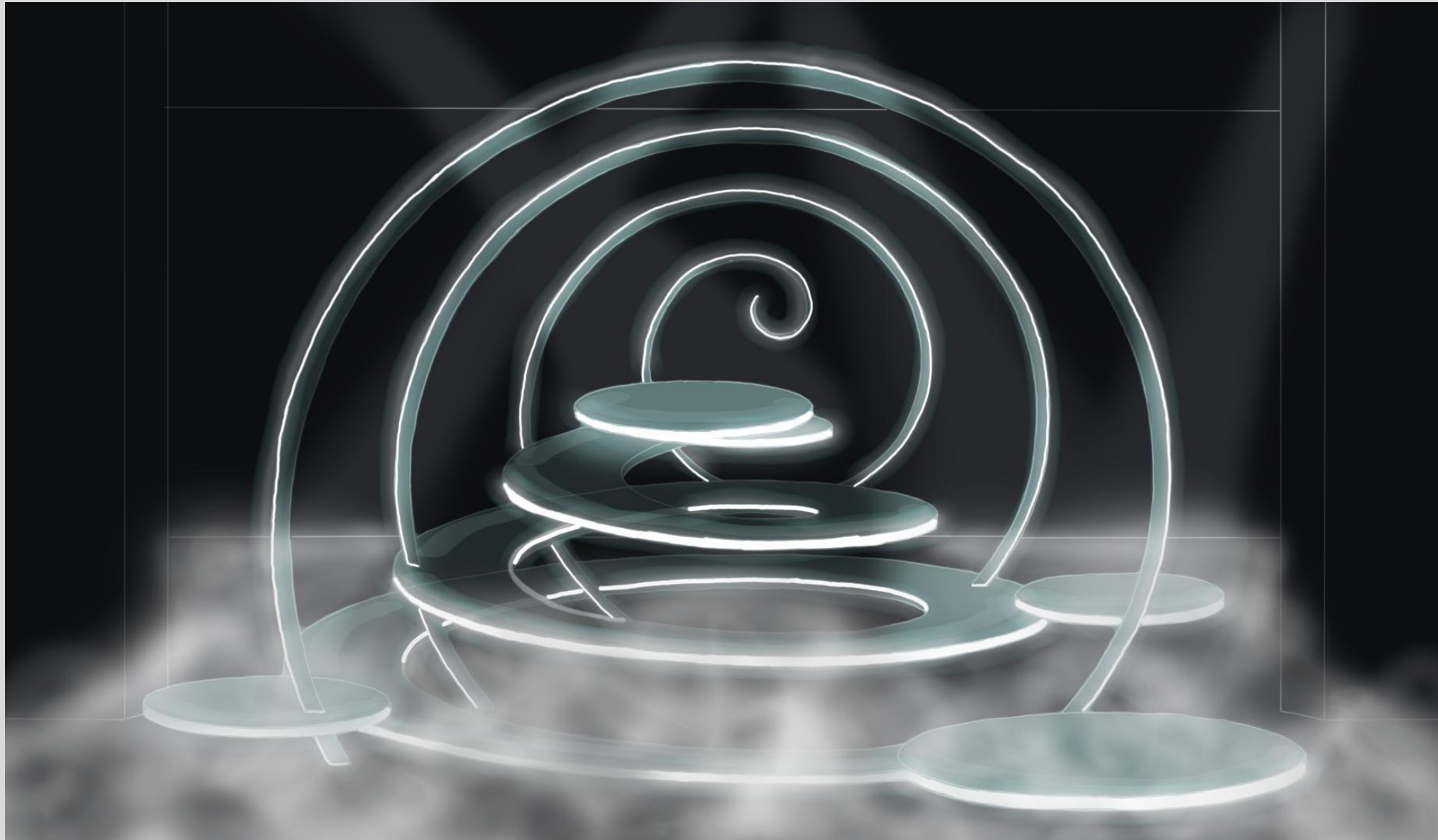
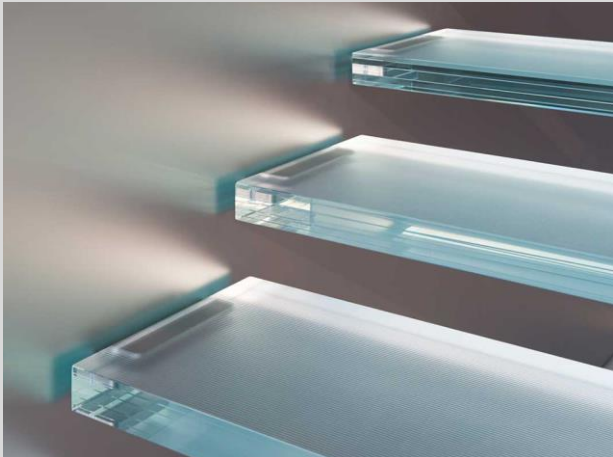

Four Plays for Dancers
Modern & Sculptural

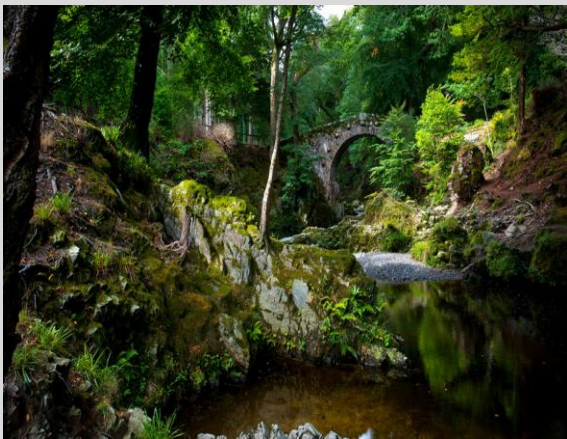

Four Plays for Dancers
Irish Nature



Gormenghast – Moodboard (2020)

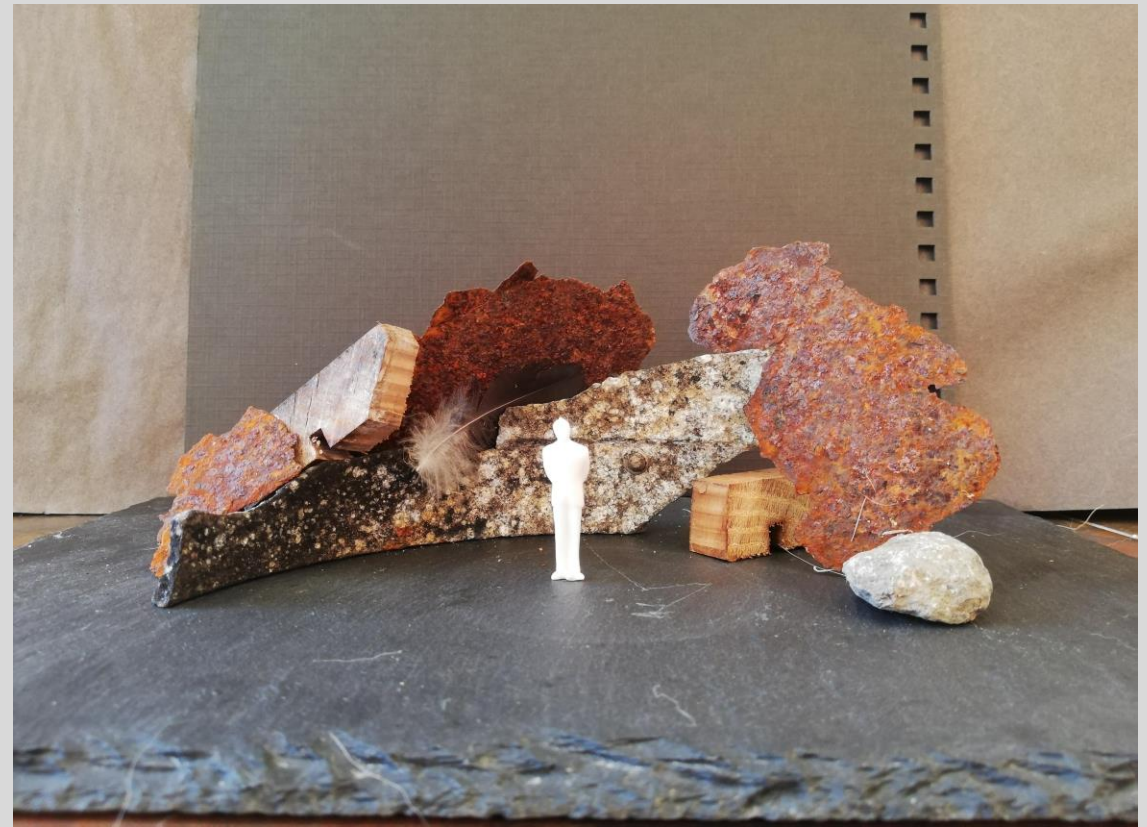

Gormenghast - Concept Models using found objects (2020)



Gormenghast - Set Design Concept (2020)

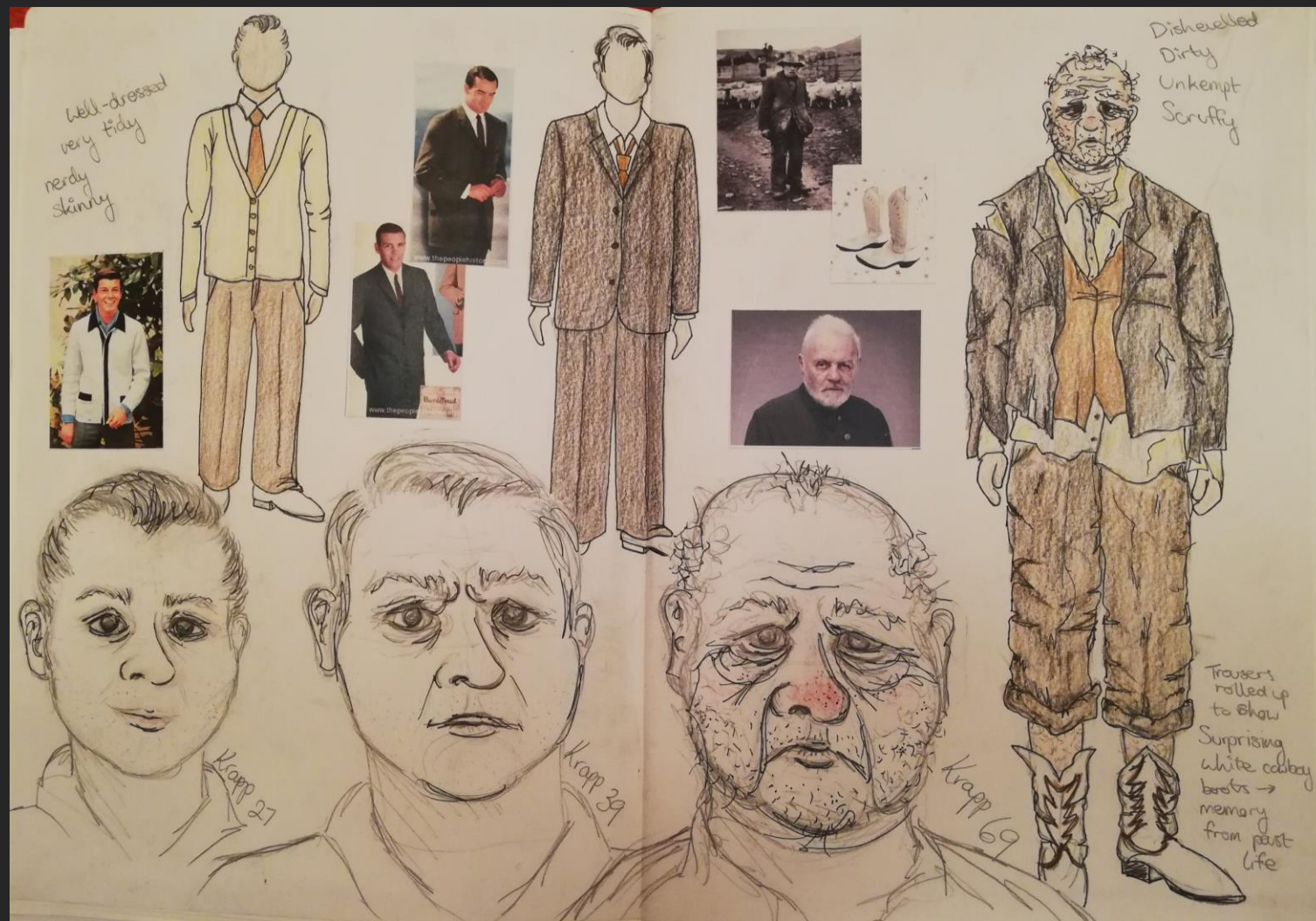

Krapp (27) – 1950s, Krapp (39) – 1960s, Krapp (69) – 1990s

'Krapp's Last Tape'

Character Designs (2019)



Fanny – 1990s



Dark Young Beauty – 1960s



Old Miss McGlome – 1950s



Bianca – 1960s



Girl in the Shabby Green Coat – 1960s



Mother – 1960s



Girl in the Punt – 1960s



Girl on the Baltic – 1960s

Reference Photos

(taken in collage)

The textures, colours, dirt & decay of these images sparked the inspiration of setting the play in a dilapidated location.



This led me to think of St. Senan's Psychiatric Hospital in Enniscorthy, Wexford. It opened in 1868 as an Asylum, then became Enniscorthy Mental Hospital in the 1920s and became St. Senan's Hospital in the 1950s. It closed in 2015.

The interior of the hospital is completely worn down ~~and~~ with paint peeling off the walls, collapsed ceilings and parts of the building have been damaged by trespassers. Many of the walls are a cold mint green.



'Krapp's Last Tape'

- Initial Research, Concept Sketch & 3D Model (2019)



'Krapp's Last Tape'
Set Design (2019)



'Animal Farm'

Costume Design for Main Characters

(2018)



'Animal Farm' - Final Costume Design - *Snowball* - (2018)

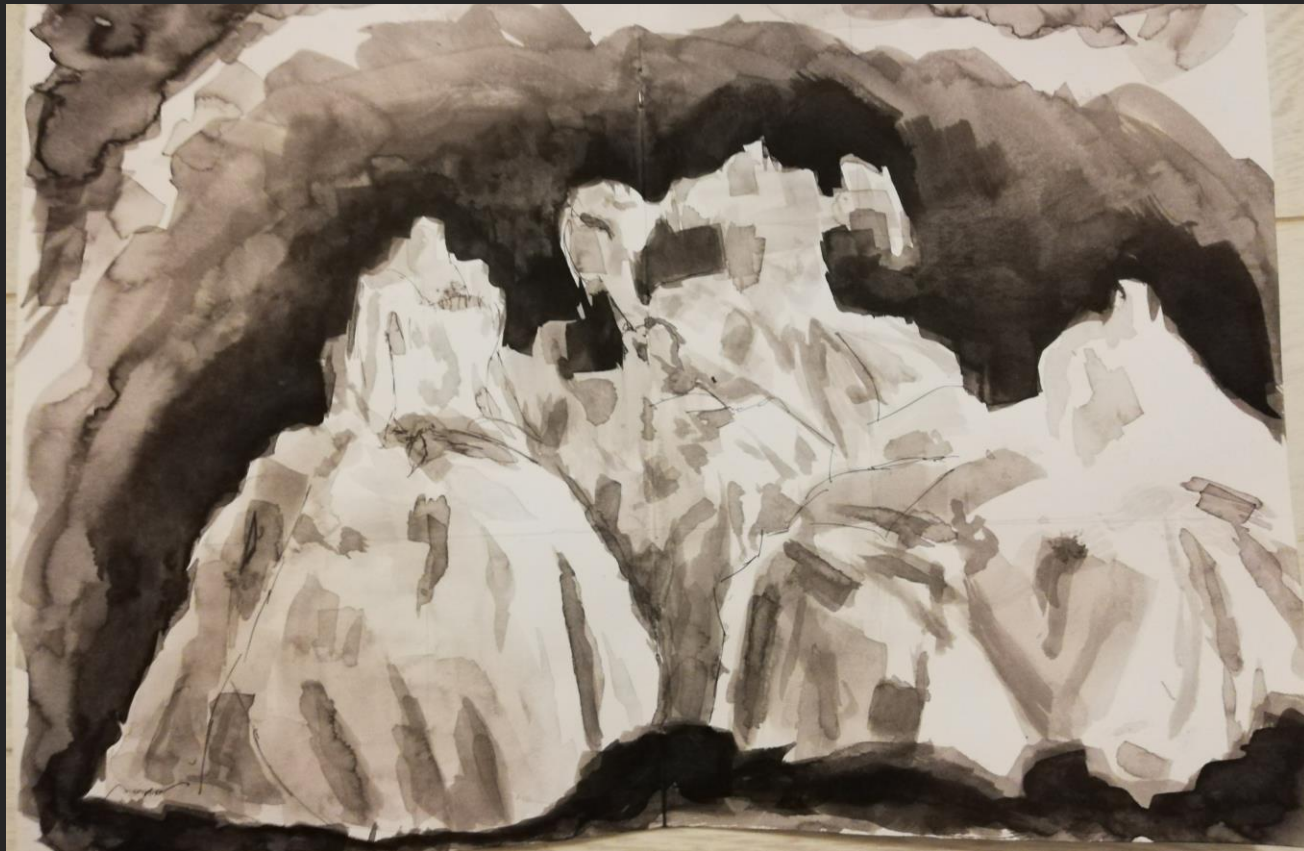

Dress Made from Paper and Tape – Experimentation with Ink & Line Drawing (2018)



Dress Made from Paper and Tape – Experimentation with Ink & Line Drawing (2018)